

Patient Service Centers (PSC)

Citrus, Lake, Marion & Sumter Counties

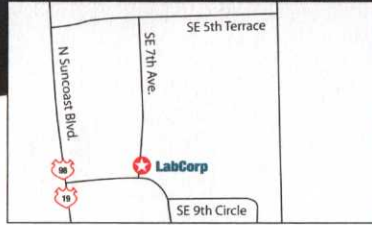

1 580 SE 7th Ave. (Terrace)
Crystal River, FL 34429
Fax: 352-564-0776

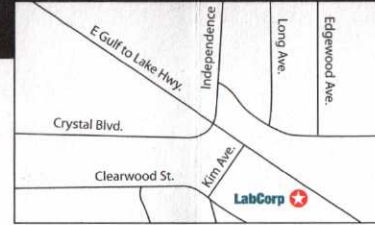

2 2525 Gulf To Lake Highway
Inverness, FL 34453
Fax: 352-341-0189

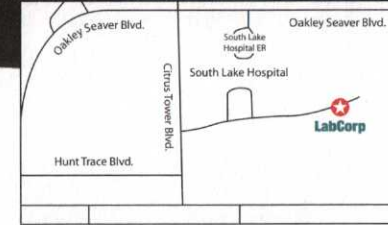

3 1920 Don Wickham Drive
Clermont, FL 34711
Fax: 352-241-0853



4 1300 E Burleigh Blvd.
Tavares, FL 32778
Fax: 352-253-0139

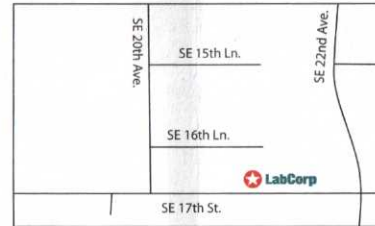

5 2100 SE 17th St. Ste. 901
Ocala, FL 34471
Fax: 352-732-4917

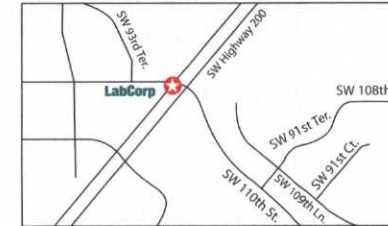

6 9401 SW State Road (Sr) 200 Building
1000 Ste. 1002 • Ocala, FL 34471
Fax: 352-861-3857



7 8600A County Rd. 466 Ste. A
The Villages, FL
Fax: 352-674-9169



8 601 East Dixie Ave. Ste 804
Leesburg, Florida 34748
Fax: 352-319-8015

SCHEDULE YOUR NEXT APPOINTMENT ONLINE

Visit www.labcorp.com to locate a site near you, then click "Find a lab," follow the simple on-screen instructions to set up your appointment, or call 800-877-3818 to have a Customer Service Representative assist you.

POST BLOOD COLLECTION INSTRUCTIONS:

- Apply direct pressure to the blood collection site.
- Leave bandage on for at least 30 minutes, unless instructed differently by your doctor.
- Avoid lifting objects over 5lbs or carrying your purse with that arm for at least 30 minutes.
- If swelling or bruising occurs, apply ice

NATIONAL EXCLUSIVE LABORATORY PROVIDER FOR UNITED HEALTH CARE

For questions or concerns regarding your visit please contact our PSC Support Group at pscsupport@labcorp.com or 877-342-0013.

If you have any further questions or concerns regarding your lab results, please contact your physician.

The PSC Locator on www.labcorp.com or at 888-LabCorp (888-522-2677) provides the most current PSC locations with driving directions.

**For additional information,
visit our website:
www.labcorp.com**



Citrus, Lake, Marion & Sumter Counties

Patient Service Centers (PSC)



Your Community Lab.

LabCorp's patient service centers are ready to meet your needs with convenient access, comfortable waiting areas, and staff offering the professional service you expect from LabCorp.